



MASTERPIECES
MADE IN GERMANY

Flow Monitor

RVM/U-S4

H₂O



OVERVIEW

Operation

- Float measuring principle

Application

- Cooling systems and cooling circuits
- Mechanical engineering
- Medical engineering
- Pharmaceutical industry
- Chemical industry
- Research & Development

Features

- Universal orientation
- High reliability
- High switch accuracy
- Infinitely variable switch point adjustment by operator
- Hose connection

Installation information

- The operating instructions for RVM/U-S4 Module BASICS must be observed!
- **Download: www.meister-flow.com**

OPERATING DATA

Operating pressure, max.	16 bar (Brass version)
Pressure drop	0,02 – 0,2 bar
Temperature, max.	100 °C (optional 160 °C)
Measuring accuracy	±10 % of full scale

MEASURING RANGES

Type	Switch range for H ₂ O at 20 °C ⁽¹⁾		
	l/min	gph	gpm
RVM/U-S4/01	0,005 – 0,06	0,08 – 0,95	
RVM/U-S4/02	0,04 – 0,13	0,65 – 2,05	
RVM/U-S4/06	0,1 – 0,6	1,6 – 9,5	
RVM/U-S4/1	0,2 – 1,2	3,0 – 19,0	
RVM/U-S4/2	0,4 – 2	6,5 – 31,5	
RVM/U-S4/3	0,5 – 3	8 – 48	
RVM/U-S4/5	1 – 5	16 – 80	

⁽¹⁾ The specified measuring- / switch ranges are valid for water having a density of 1.00 kg/dm³, vertical installation of the device and flow direction from bottom to top.

Other installation positions or deviation from the operating densities will increase the measurement error specified in the data sheet.

Operating density for water at 20 °C and 1.013 bar (absolute value): 1.00 kg/dm³.

Upon request, special scales for deviating media, different operating conditions and installation positions (only for devices which can be installed in any position) are available.

The specified switch values are switch-off points, i.e. switch values by decreasing flow.

Other measuring- / switch ranges are available upon request.

MATERIALS

Brass version, wetted parts

Spring:	1.4571
Magnets:	Hard ferrite
Device body:	Brass
Gaskets:	NBR (optional FKM, EPDM)
all other wetted parts:	Brass



Proudly Distributed By

TRIDENT AUSTRALIA
FLUID SYSTEMS & COMPONENTS

TECHNICAL DRAWING

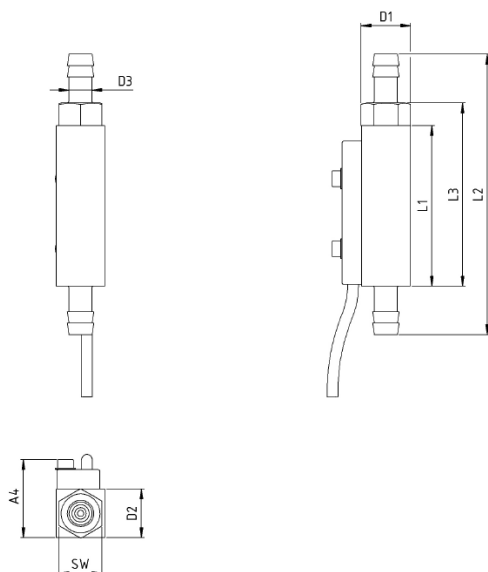

SUMMARY OF TYPES

Type	Overall dimensions [mm]												Weight approx. [g]
	G	DN	SW	L1	L2	L3	D1	D2	D3	A2	A3	A4	
RVM/U-S4/01 -	8	15	56	98	64	17,3	17	8	-	-	28	160	
RVM/U-S4/02 -	8	15	56	98	64	17,3	17	8	-	-	28	160	
RVM/U-S4/06 -	8	15	56	98	64	17,3	17	8	-	-	28	160	
RVM/U-S4/1 -	8	15	56	98	64	17,3	17	8	-	-	28	160	
RVM/U-S4/2 -	8	15	56	98	64	17,3	17	8	-	-	28	160	
RVM/U-S4/3 -	8	15	56	98	64	17,3	17	8	-	-	28	160	
RVM/U-S4/5 -	8	15	56	98	64	17,3	17	8	-	-	28	160	

RVM/U-S4 3 0001 12-15 E M

ELECTRICAL DATA

Normally open (NOC)	140V AC · 0,7A · 20VA
	200V DC · 1A · 20VA

ELECTRICAL CONNECTION

- Cable (1 m)

Ingress Protection

IP67: Cable

Output signal

The contact opens when the flow decreases below the set point.

Power supply

Not required (potential-free reed contacts)

Connector types

Other cable lengths on request

CONNECTION DIAGRAM

Braun
brown
marron

2

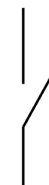

1

Schwarz
black
noir

RVMU-S4 4 0001 12-15 E M